



CYL REVOLVE

CYLINDER



FEATURES

- Ideal for new construction and remodeling applications
- Dimmable
- Suitable for damp locations
- Selectable color temperature
- Wattage Selectable
- Interchangeable mounting options
- Black and White finish options
- Universal voltage

Mounting Options

- Surface
- Mud-In Trimless
- Pendant Cord (49" Adjustable)
- Conduit Mount
- Stem Mount (5" Stackable Configurations)

SPECIFICATIONS

Wattage	10W/15W/20W Selectable
Input Voltage	120V - 277V
Efficacy	90lm/W
Lumens	1800LM
Color Temperature	27K, 30K, 35K, 40K, 50K(CCT adj.)
Dimming	Triac/ 0-10V

CRI	90
Environment	Damp Locations
Beam Angle	40°
Lamp Life	50,000hr
Operating Temperature	-4°C ~ 104°C



PROJECT:

PREPARED BY:

TYPE:



CYL REVOLVE

CYLINDER

ORDERING GUIDE

CYL - _____ - CCT - _____ **Example: CYL-WS-CCT-WT**

Model	Wattage	Lumens	Color Temperature	Voltage	Finish
CYL	WS 10/15/20W Selectable 20 20W	900/1350/1800LM 1800LM	CCT Adj (2700K/3000K/3500K/4000K/5000K)	120-277	WT White BK Black

MOUNTING KIT

CYL - _____ - _____ - _____ **Example: CYL-SFC-WT-EM**

Model	Mounting Option	Finish	EM
CYL	SFC Surface	WT White	EM
	TMS Trimless	BK Black	(Leave blank for non-em)
	PDT Pendant		
	CM Conduit Mount (Not compatible with EM option)		
	ST Stem Monopoint		
	ST__ Stem Mount Ultra (Intervals of 6" or 12")		
	STU__ Stem Mount Ultra Slim Canopy (Intervals of 6" or 12")		
	STR__ Stem Mount Ultra Recessed Canopy (Intervals of 6" or 12")		

PROJECT:

PREPARED BY:

TYPE:



CYL REVOLVE

CYLINDER



Twist off mounting kit and quick connect wires allow for quick and efficient installation.

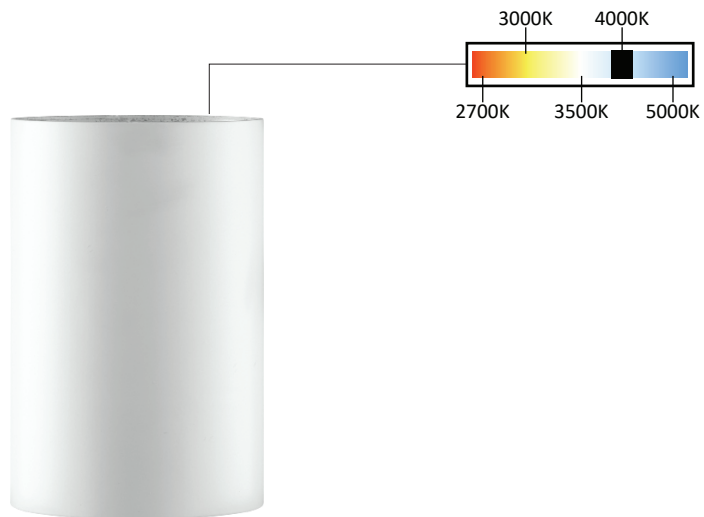
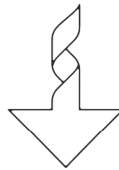



CYL

REVOLVE

CYLINDER

DIMENSION

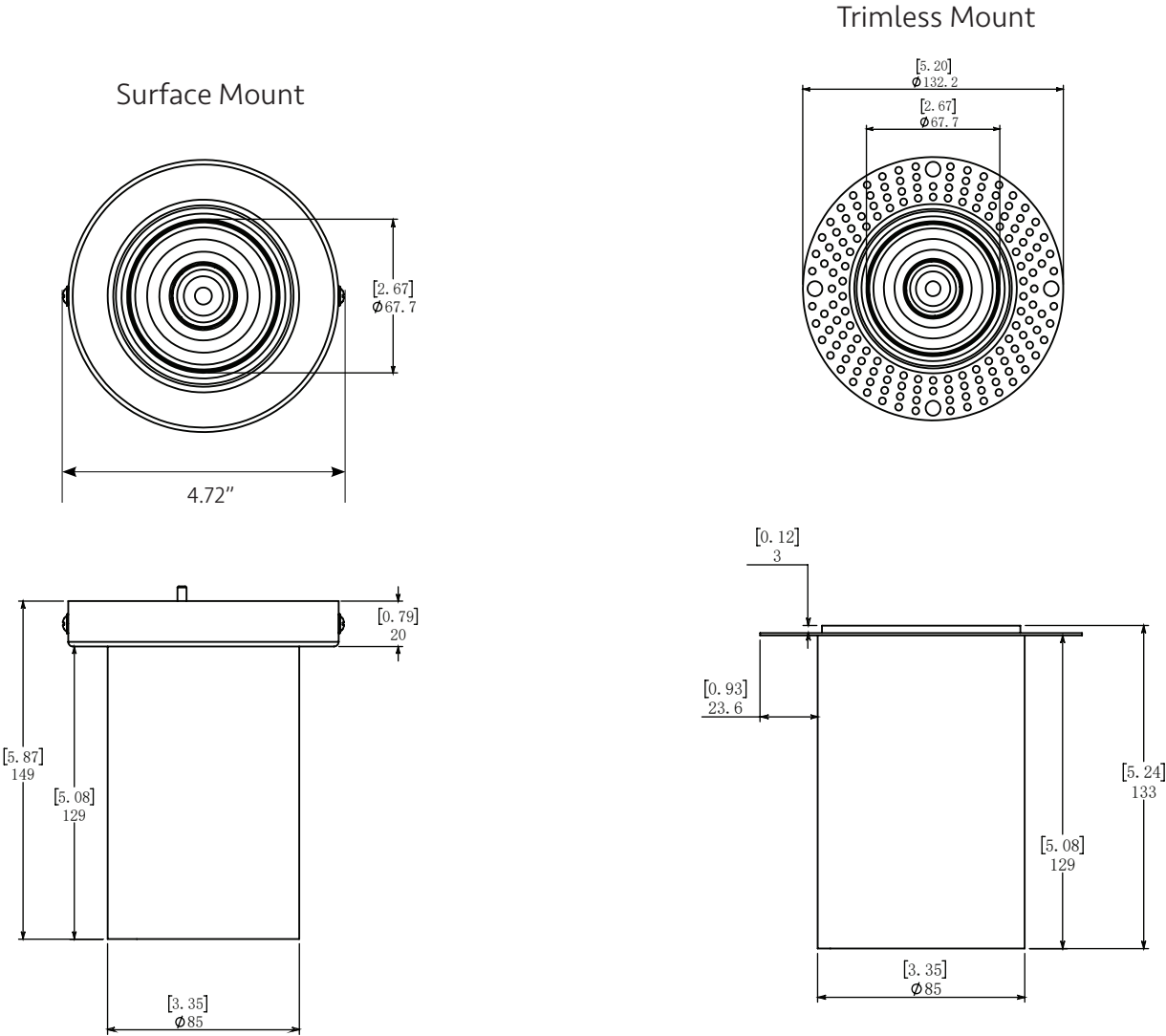



CYL REVOLVE

CYLINDER

DIMENSION

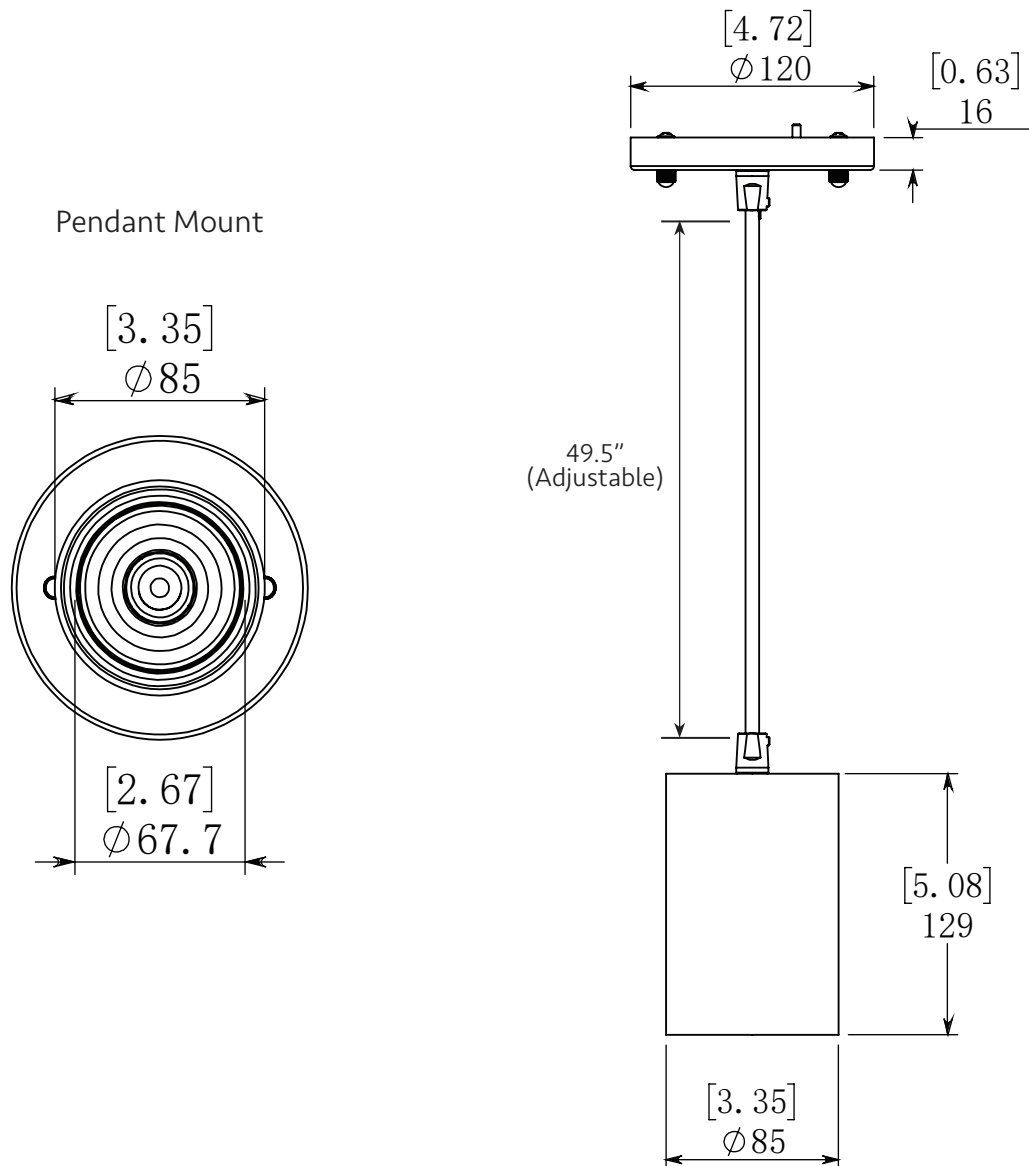

PROJECT:

PREPARED BY:

TYPE:



CYL REVOLVE

CYLINDER

AVAILABLE CANOPY



Stem Mount Ultra



Stem Mount Ultra Slim Canopy



Stem Mount Ultra Recessed Canopy

DIMENSION

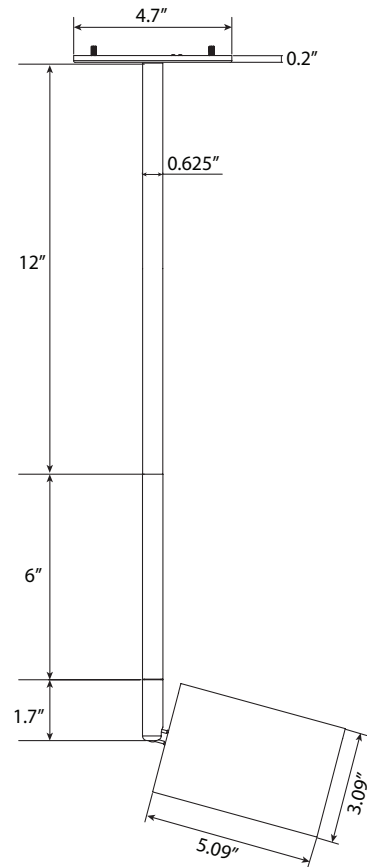
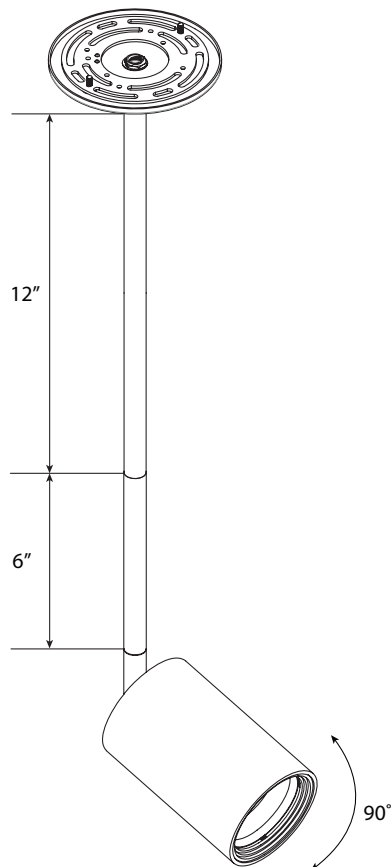

PROJECT:

PREPARED BY:

TYPE:



CYL REVOLVE

CYLINDER

DIMENSION

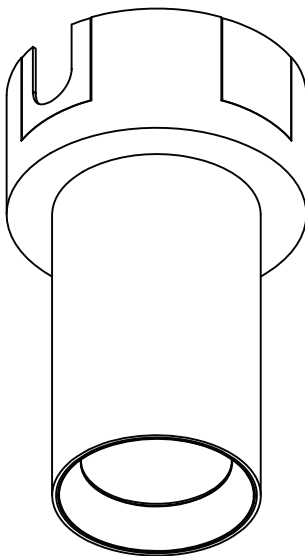
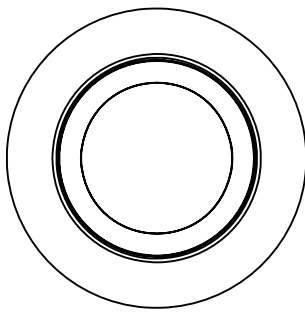

Conduit Mount

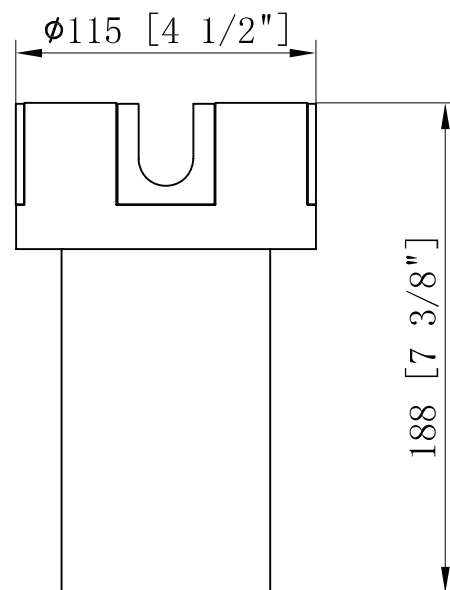

*Conduit Mount Kits are not compatible with EM option



CYL REVOLVE

CYLINDER

EM BATTERY

SPECIFICATIONS

Input Voltage	100-34 7Vac, 50/60Hz
Input Current	0.1A MAX
Input Power	12W MAX
Output Voltage	170V DC
Output Power	20W
Application	≤150W (0-10V Dimmable Fixture) ≤20W LED Lamps without dimming function
Ambient Temperature	Damp Locations



CAUTION:

1. The Emergency LED driver must connect to 0/1-10V dimming wires (DIM+, DIM-) of the fixture if the LED luminaire power is exceed the emergency LED driver power.
2. In emergency mode, double-click this test switch to turn off the current emergency state.

WIRING DIAGRAM

Wiring 1 : For LED Driver with Input Power Higher Than Emergency Output Power

0/1-10V Dimmable LED Driver+ Dimmer Switch

Emergency Driver Dim+(Green), Driver Dim-(Yellow) Have to connect with LED driver DIM+ and DIM-

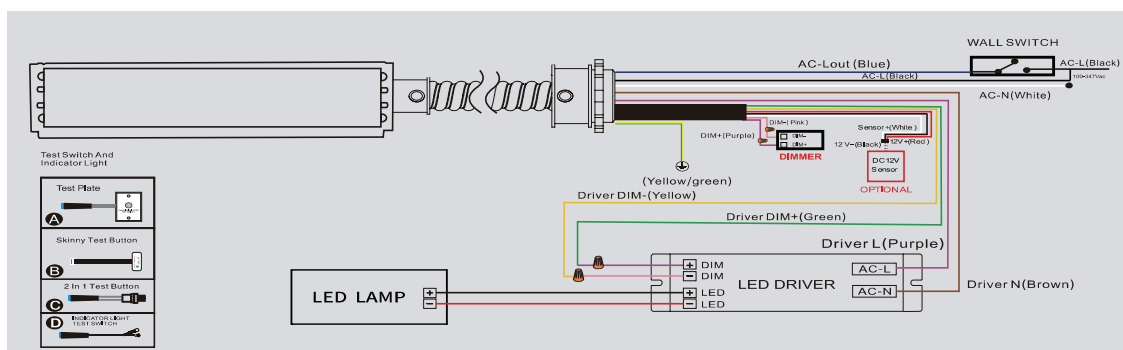



CYL
REVOLVE
CYLINDER

Wiring 2 : For LED Driver With Input Power Higher Than Emergency Output Power

0/1-10V Dimmable LED Driver+ Wall Switch

Emergency Driver Dim+(Green) , Driver Dim-(Yellow) Have to connect with LED driver DIM+ and DIM-

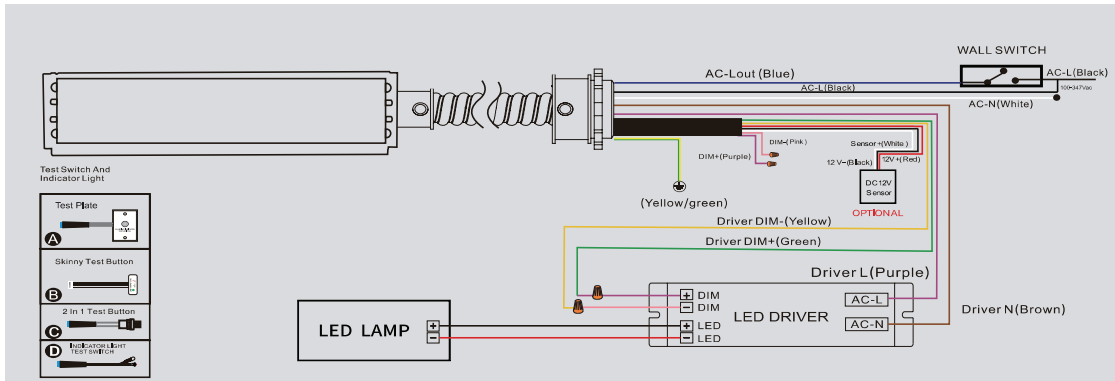

Wiring 2 : For LED Driver With Input Power Higher Than Emergency Output Power

0/1-10V Dimmable LED Driver+ Wall Switch

Emergency Driver Dim+(Green) , Driver Dim-(Yellow) Have to connect with LED driver DIM+ and DIM-

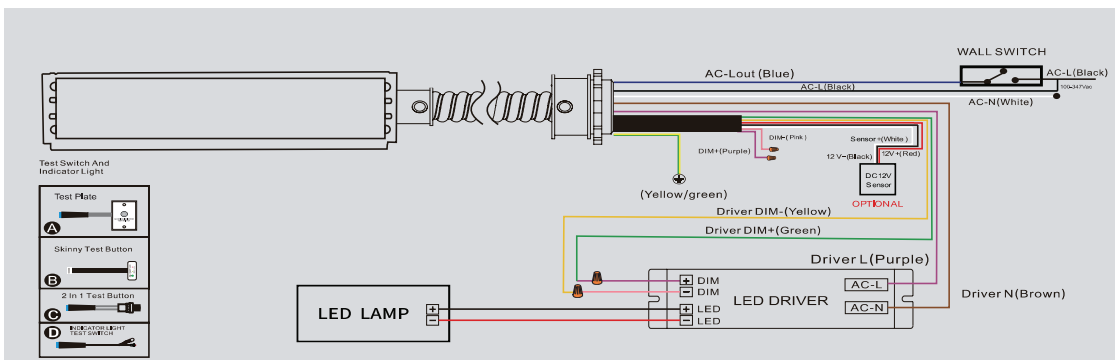

IMPORTANT SAFEGUARDS

When using electrical equipment, basic safety precautions should always be followed including the following

PLEASE READ AND FOLLOW ALL SAFETY INSTRUCTIONS.

CAUTION:RISK OF SHOCK-disconnect emergency and normal input power sources before servicing any equipment connected to this unit.

CAUTION: Risk of fire or electric shock-This emergency battery pack installation requires knowledge of luminaire and electrical systems.

CAUTION: Servicing of this equipment should be performed by qualified personnel only.

CAUTION: Before installation, make certain the AC power to fixture is off.

CAUTION: Verify that all replacement lamp types marked on the installed luminaire are also identified as suitable for use with this emergency battery pack.

CAUTION: Suitable for use in 5°C -50°C ambient temperatures.

IMPORTANT: An unswitched AC power source is required (100-347 VAC, 50/60 Hz). This device is designed for fixtures listed for dry and damp locations.

CAUTION: Do not use outdoors. Do not mount near gas or electric heaters.

CAUTION: Equipment should be mounted in locations and at heights where it will not be subjected to tampering by unauthorized personnel.

CAUTION: The use of accessory equipment not recommended by the manufacturer may cause an unsafe condition. The emergency battery pack is not for use in an air-handling fixture.

CAUTION: Do not use this equipment for other than its intended use.



CYL
REVOLVE
CYLINDER

Emergency Battery for Surface Mount Kit

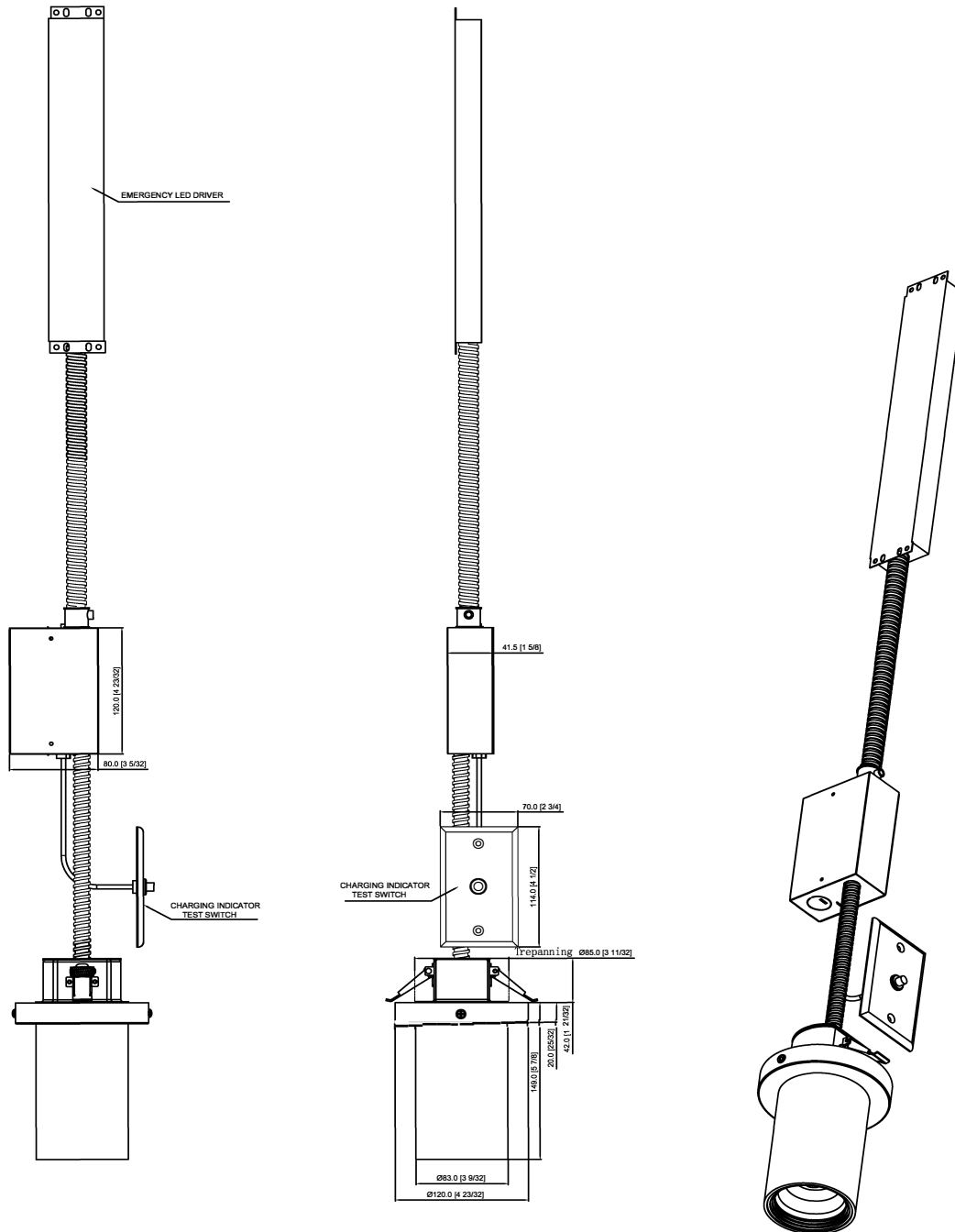



CYL REVOLVE

CYLINDER

Emergency Battery for Pendant Mount Kit

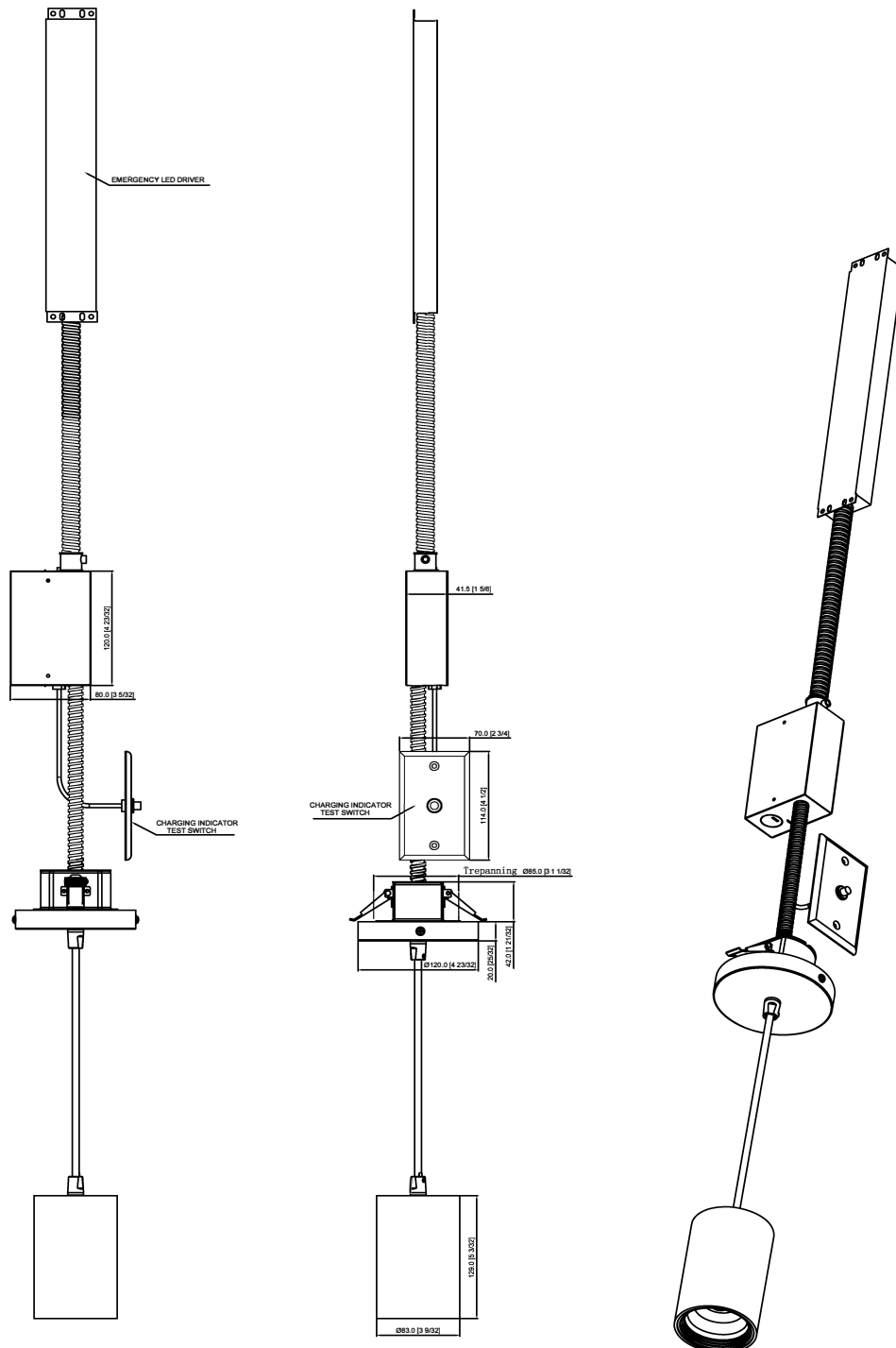

PROJECT:

PREPARED BY:

TYPE:



CYL REVOLVE

CYLINDER

COMPATIBLE DIMMERS

LUTRON	LOAD (W)
SKYLARK CONTOUR LECL-153P	150W
SKYLARK CONTOUR CTCL-150H	150W
SKYLARK CONTOUR LGCL-153PLH	150W
SKYLARK CONTOUR CTCL-153P	150W
SKYLARK CONTOUR SCL-153P	150W
SKYLARK CONTOUR S-600P	600W
CASETA PD-6WCL	600W
CASETA PD-5NE	150W
CASETA PD-10NXD	250W
DIVA DVCL-153P	150W
TOGGLER TGCL-153P	150W
ARIADNI AYCL-153P	150W
MAESTRO MACL-153M	150W

LEVITON	LOAD (W)
ILLUMATEC IPL06	150W
SURESLIDE 6672	150W
SURESLIDE 6674	150W
EATON	
SMART DIMMER AAL06	300W
PASS & SEYMOUR	
HARMONY DCL453PTCCCV6	150W
GE	
ROCKER 10464	150W
TOGGLE 18027	150W