

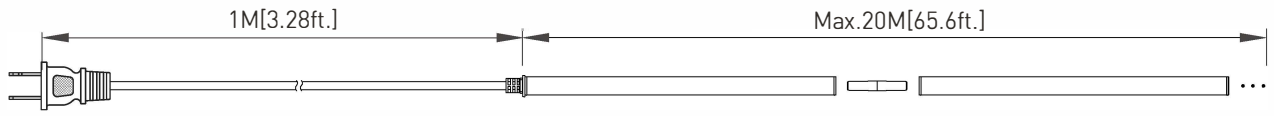

SEAMLESS LINKABLE LED LUMINARY RIB AC

INSTALLATION GUIDE



120VAC input power cable with AC plug and straight plug linear light extension connector linear light

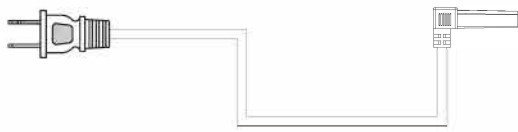

power cable with AC plug and 90° corner plug

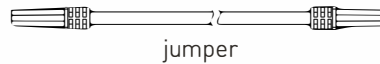

jumper

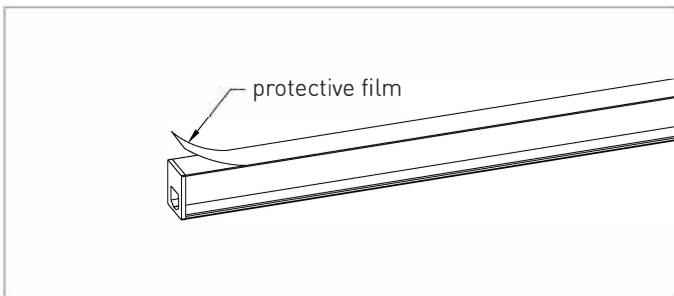

protective film

Step 1: Peel off the protective film on the light emitting surface.

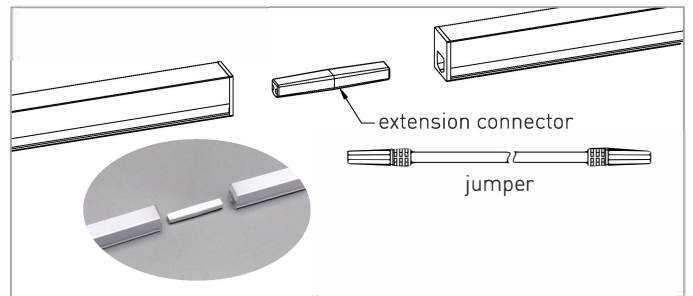

extension connector

jumper

Step 2: Splicing multiple products by extension connector or jumper.

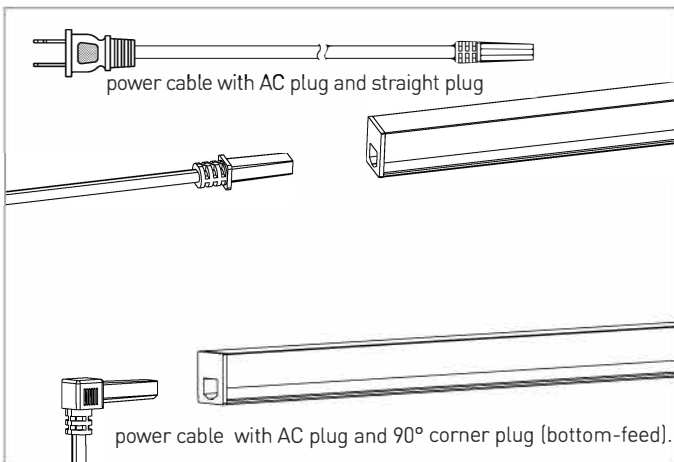

power cable with AC plug and straight plug

power cable with AC plug and 90° corner plug (bottom-feed).

Step 3: Insert the power cable into the product.

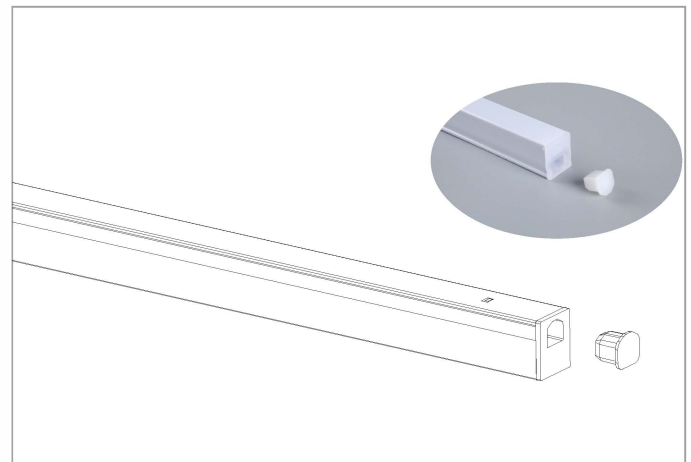

Step 4: Seal the terminal socket by inserting the rubber end cap, which is required for the product at the tail in the same string.